

# 4050 PULLSTATIONS

## SAFETY MESSAGE TO INSTALLERS

People's lives depend on your safe installation of our products. It is important to read, understand and follow all instructions shipped with this product. In addition, listed below are some other important safety instructions and precautions you should follow:

- This unit should be installed by a qualified electrician in accordance with NFPA 72, and national and local Electrical and Fire Codes, under the direction of the authority having jurisdiction.
- If the unit is not installed in a supervisory system, it must be tested at regular intervals. Refer to NFPA 72G and the local Fire Codes for this information.
- After installation and testing are complete, provide a copy of this instruction sheet to all personnel responsible for routine testing and maintenance of this equipment.

Failure to follow all safety precautions and instructions may result in property damage, serious injury, or death to you or others.

### A. GENERAL.

Models 4050-001T and 4050-211T non-coded pull stations are Underwriters Laboratories listed for "Fire Protective Signalling Use" (category designation UNIU). These switch activated units are designed to initiate an electronic warning signal when the pull bar (marked "PULL DOWN") is manually pulled downward. An optional break shield is available for dual-action pull station requirements. The pull station is available for field input wiring in either a 4-wire version or a terminal version (see figure 1).

ADA compliant units will be noted on the backplate label. If so marked, these units (with or without break shield) comply with the maximum pull force of less than 5 lbs. as required by the Americans with Disabilities Act (ADA).

### B. INSTALLATION.

#### 1. Unpacking.

After unpacking the pull station, examine it for damage that may have occurred in transit. If the unit has been damaged, do not attempt to install or operate it. File a claim immediately with the carrier stating the extent of the damage. Ensure that the parts listed in the KIT CONTENTS LIST are contained in the packing carton.

#### 2. Electrical Connections.

#### DANGER

To avoid electrical shock, DO NOT attempt to install the station(s) when power is on.

#### WARNING

Property damage, serious injury, or death in the protected premises may occur if wiring is improperly terminated. For proper warning system operation, ensure that the wires to the pull stations are properly terminated.

#### a. 4-Wire Version (Model 4050-001T).

See figure 2. The 4-wire version of the 4050 pull station has two red and two black wires attached (soldered) to the switch and secured to the pull station with a nylon strain relief. One set of wires (one black and one red) is used for the incoming signal; the other set is used for the outgoing signal. This wiring arrangement provides the NFPA 72 electrical supervision requirement.

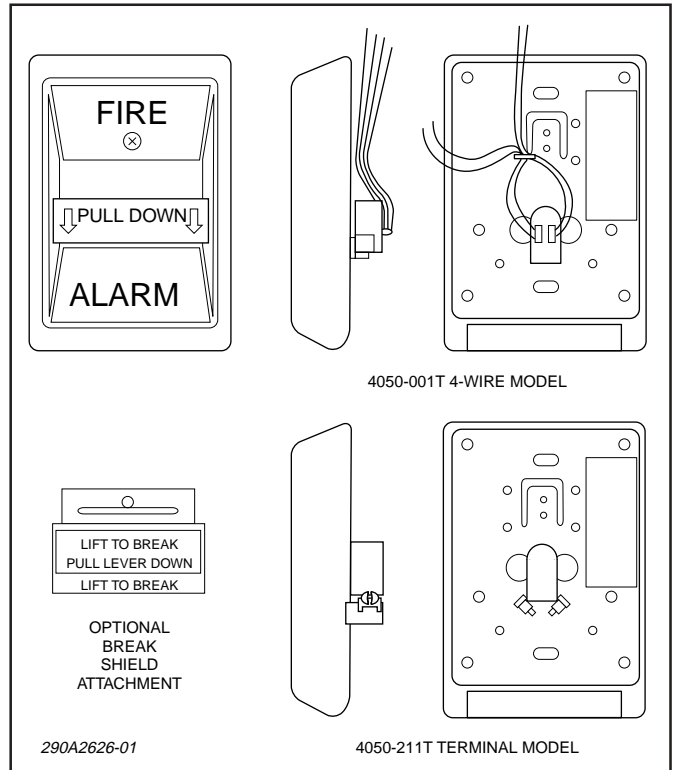

Figure 1.

Use the proper size wire nuts or crimp terminals to secure all connections between adjoining stations and the power source.

#### b. Terminal Version (Model 4050-211T).

#### WARNING

An uninsulated section of a single conductor MUST NOT be looped around a terminal and used as two separate connections. NFPA 72 requires that the wire is severed to provide electrical supervision of the connection.

Use 14 AWG (maximum) field wiring leads for the pull stations.

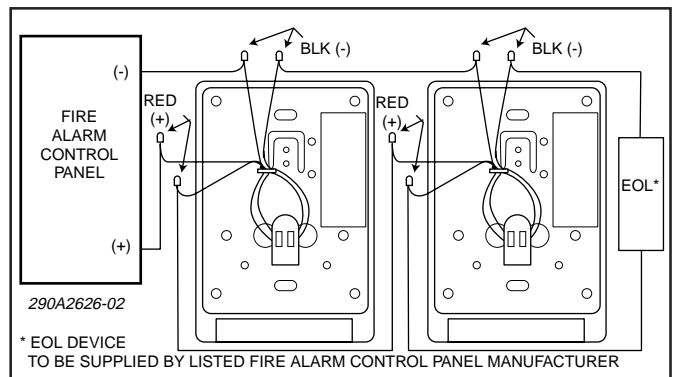

Figure 2.

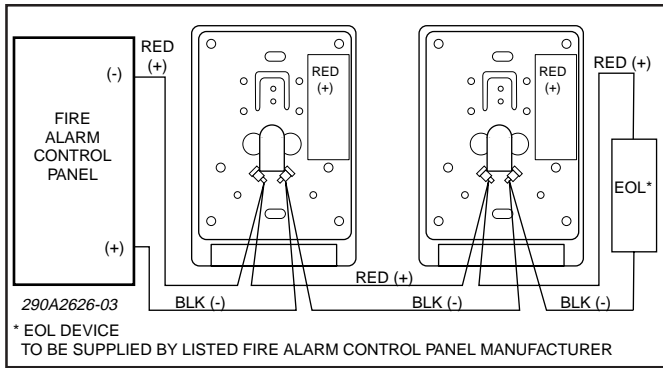

Figure 3.

See figure 3. Two U-shaped saddle clamp-type terminals are supplied on the pull station for electrical connections. Strip 3/8" of insulation from all wiring leads. Attach the appropriate wires to the corresponding terminals of the back of the pull station. The red terminal indicates the positive lead. Securely tighten both of the binding screws to firmly capture the wires within the saddle clamps.

3. Mounting Arrangements.

**WARNING**

Property damage, serious injury or death could occur in the protected premises if you do not follow the correct closing procedure. Before closing the station, ensure that the switch is in the "up" (normally open) position (see figure 4), and that the mounting screws do not interfere with the internal mechanism and closing of the station.

- a. Semi-flush Mounting (see figure 4).

The Model 4050 pull stations are designed for mounting on an existing approved single gang electrical box or a 4" x 4" electrical box with a raised single gang plaster ring.

To open the pull station, loosen the #6-32 access screw located on the front of the unit. Use the two supplied #6-32 screws to secure the pull station in the electrical box. Close the station and firmly secure with the previously loosened #6-32 access screw.

- b. Surface Mounting (see figures 4 and 5).

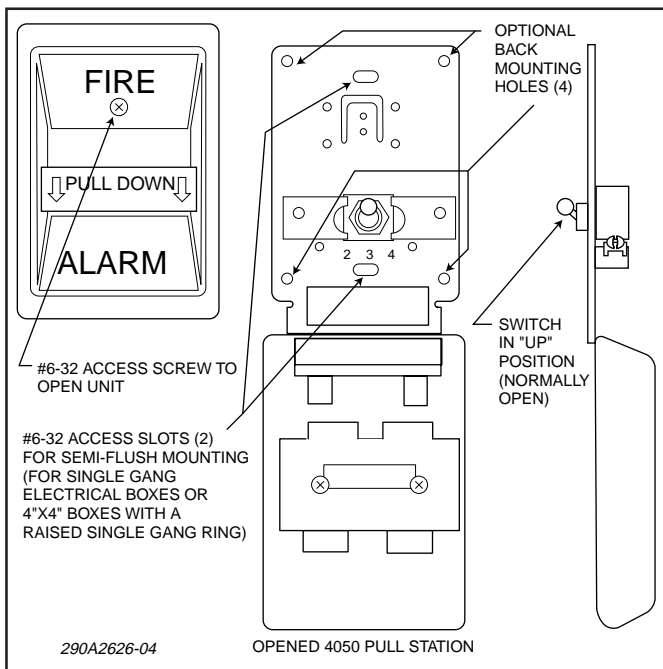

Figure 4.

The Model 4050 pull stations are also designed for mounting on an optional 1-1/2" deep Model 4050BB backbox.

To open the pull station, loosen the #6-32 access screw located on the front of the unit. Use four #8-32 screws (user-supplied) to secure the pull station on the backbox. Close the station and firmly secure with the previously loosened #6-32 access screw.

**C. TEST AFTER INSTALLATION.**

Check for proper operation of all pull stations installed in your system.

**D. OPTIONAL BREAK SHIELD INSTALLATION.**

To install the dual-action break shield after testing, loosen the #6-32 access screw and open the station. Pull down the pull bar and insert the shield's top leading edge beneath the "FIRE" nameplate. Release the pull bar and confirm that the shield is now held firmly in place, and completely covers the pull bar (see figure 5). Also ensure that the access screw is firmly tightened, securing the station front face.

**E. MAINTENANCE/SERVICE.**

**NOTE**

A copy of this installation sheet must be given to all personnel responsible for routine testing and maintenance of this equipment.

The factory will service this unit or provide technical assistance with any problem that cannot be handled locally with satisfaction or promptness. If any unit is returned to the factory for repair, it can be accepted only if we are notified by mail or phone in advance of its arrival. Such notice should clearly indicate the service requested and give all pertinent information regarding the nature of the problem and, if possible, its cause.

This product is covered by a 5 year limited warranty. See CPG terms and conditions.

Communications and shipments should be addressed to the following:

Technical Service Department  
 Commercial Products Group  
 2519 - 4th Avenue  
 Moline, IL 61265  
 800.521.8219 • FAX 800.225.4109

**F. KIT CONTENTS LIST.**

Qty.	Description
1	Model 4050 Pull Station
2	#6-32 Mounting Screws
1	Installation Instructions

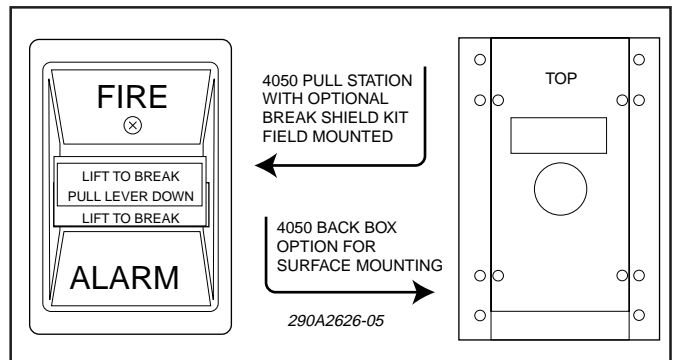

Figure 5.